

# WM12Q DuraLED Small Nautilus LED Post Top



Project Name:	<b>Project Information</b>	Fixture Type:
Complete Catalog #:		Date:
Comments:		

The DuraGuard WM12Q Small Nautilus Architectural Decorative Post Top is available in Type II, III, IV or V distributions designed to replace HID lighting systems up to 100w MH or HPS. The fixture mounts to a pole top tenon. Typical area lighting applications include parking areas, walkways, and street lighting applications. Mounting heights of 8 to 16 feet can be used based on light level and uniformity requirements.

## SPECIFICATIONS AND FEATURES:



### HOUSING:

Die Cast Aluminum Housing, Integral Heat Sinking, Photocell Adaptable.

### LISTING & RATINGS:

CSA: Listed for Wet Locations, ANSI/UL 1598, 8750  
IP66 Sealed LED Compartment.

### FINISH:

Black Powdercoat Finish Over a Chromate Conversion Coating. Custom Colors Available Upon Request.

### LENS:

Clear UV-Stabilized Polycarbonate Vandal-Resistant Array Lens with Integral Optics. Gasketed to Seal LED Array.

### MOUNTING:

Post Top Accommodates "P3" 2½" O.D. x 3" Tenon, Wall Mount Includes Cast Aluminum Arm (Wall Attachment Hardware NOT Included, Must be Selected and Provided By Contractor), and Pendant Mount Includes 15" Swivel Stem for Mounting on Flat or Sloped Ceilings.

### DURALED LED:

Aluminum Boards

### WATTAGE:

10w Array: 10w, System: 10.3w; (50w HID Equivalent)  
19w Array: 19w, System: 20.5w; (170w HID Equivalent)  
28w Array: 28w, System: 30.8w; (100w HID Equivalent)

### DRIVER:

Electronic Driver, 120-277V, 50/60Hz or 347-480V, 50/60Hz (28w Model Only); Less Than 20% THD and PF>0.90. Standard Internal Surge Protection 2kV. 0-10V Dimming Standard for a Dimming Range of 100% to 10%; Dimming Source Current is 150 Microamps.

### CONTROLS:

Fixtures Ordered with Factory-Installed Photocell or Motion Sensor Controls are Internally Wired for Switching and/or 1-10V Dimming Within the Housing. Remote Direct Wired Interface of 1-10V Dimming is Not Implied and May Not Be Available, Please Consult Factory. Fixtures are Tested with DuraGuard Controls and May Not Function Properly With Controls Supplied By Others. Fixtures are NOT Designed for Use with Line Voltage Dimmers.

### WARRANTY:

5-Year Warranty for -40°C to +50°C Environment.

See Page 4 for Projected Lumen Maintenance Table.



**WM12Q  
DuraLED Small  
Nautilus Round Post Top**



**WMWS12Q  
DuraLED Small  
Nautilus Wall Mount**

**WMP12Q  
DuraLED Small  
Nautilus Pendant Mount**

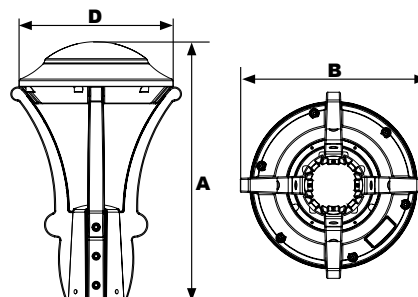

### Dimensions

<b>Diameter (D)</b>	10½" (264mm)
<b>Height (A)</b>	17½" (445mm)
<b>Width (B)</b>	11½" (294mm)



Specifications subject to change without notice.

# WM12Q DuraLED Small Nautilus LED Post Top



Complete Units Ordering Information  
 Example: **WM12QF1X28U5KCBR7**

## WM12Q DuraLED Small Nautilus LED Post Top

**C**

Model	Optics	Wattage	Driver	CCT	Lens	Color	Options
	<b>B</b> =Type II <b>C</b> =Type III <b>D</b> =Type IV <b>F</b> =Type V	<b>1X10</b> =10w <b>1X19</b> =19w <b>1X28</b> =28w	<b>U</b> =120-277V <b>H</b> =347-480V* *28w Models Only	<b>3K</b> =3000K <b>4K</b> =4000K <b>5K</b> =5000K		<b>B</b> =Black <b>C</b> =Custom (Consult Factory)	

**C**=Clear UV-Stabilized Polycarbonate Array Lens

**WM12Q**=DuraLED Small Nautilus Post Top  
**WMWS12Q**=DuraLED Small Wall Mount Nautilus  
**WMP12Q**=DuraLED Small Pendant Mount Nautilus

**P2AB**=PSRTN Tenon Adaptor, Black  
**P2AC**=PSRTN Tenon Adaptor, Custom Color (Consult Factory)  
**SF**=Single Fuse\*  
**DF**=Double Fuse\*  
**SP**=Surge Protection  
**R3**=3-Pin Twist Lock Photocell Receptacle  
**R5**=5-Pin Twist Lock Photocell Receptacle  
**R7**=7-Pin ANSI C136.41—2013 Twist Lock Photocell Receptacle  
**S3**=Microwave Sensor with Dimming for Mounting Heights of 8' to 26'.\*  
**BU**=Battery Backup, 90 Minutes\*  
**BUC**=Cold Start Battery Backup, -20°C, 90 Minutes\*

\*120-277V Models Only.

### ACCESSORIES & REPLACEMENT PARTS:

Mounting Accessories (Order Separately, Field Installed)	
PSRTN*	Retrofit Tenon Adaptor, Die Cast with Powdercoat Finish, Hardware Included. Converts a 2 3/4" x 4" Pole Tenon to a 2 1/4" x 3" Tenon.
*Specify Color: B=Black, C=Custom (Consult Factory)	



**PSRTN**

Accessories (Order Separately, Field Installed)	
P18131	Twist Lock Non-Shorting (Open) Cap Disconnects Service to Fixture for Temporary or Permanent Disabling (Fixture Always Off). IP65, 480V Maximum.
P18132	Twist Lock Shorting Cap Provides Fixed Service to Fixture (Fixture Always on). IP65, Rated Load 7200w Tungsten.
P18140	110-120VAC Instant Twist Lock Photocell
P18152	277VAC Time Delay Twist Lock Photocell
P18156	120-277VAC Universal Twist Lock Photocell
P18157	480VAC Time Delay Twist Lock Photocell. For 480V use only.
P17122	Remote Programming Tool for P17121



**P18131**



**P18132**



**P18140**



**P18152**



**P18156**  
**P18157**



**P17122**

Replacement Parts (Order Separately, Field Installed)	
PK3415	Pendant Mount Kit Includes Top & Bottom Cover, Brackets, 3/4" Dia X 15" L Downrod, and Hardware. Powdercoat Finish
P17121	Internal Microwave Sensor with Dimming for Mounting Heights of 8 to 26'. 120-277VAC, 50/60Hz
For Replacement Battery Backup, see the DuraGuard LED Battery Backup Specification Sheet.	



**PK3415**



**P17121**

### EPA (EFFECTIVE PROJECTED AREA)

Configuration	EPA (Sq. Ft.)	Weight (Lbs.)
	0.8	14 Lbs

Specifications subject to change without notice.

# WM12Q DuraLED Small Nautilus LED Post Top



## PHOTOMETRIC DATA

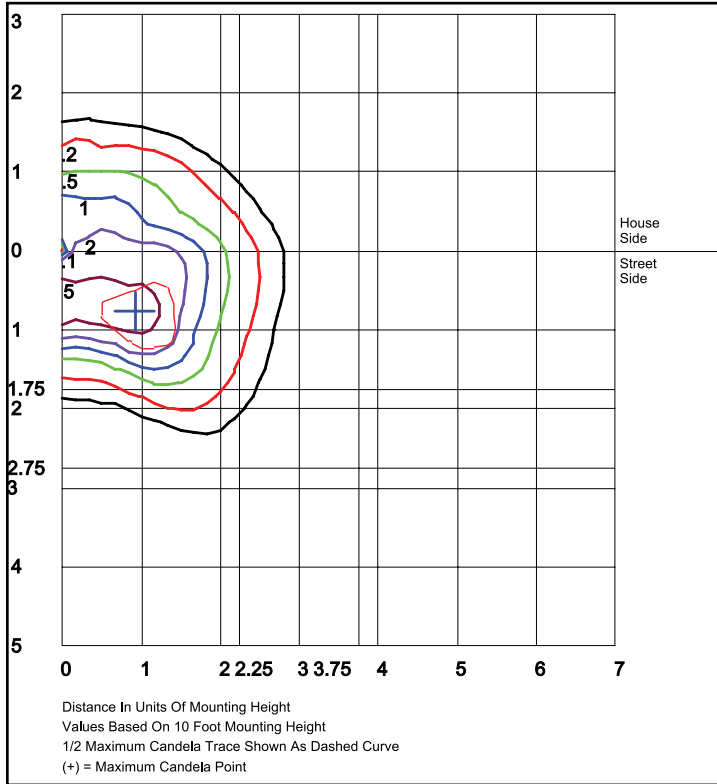

**WM12QB1X28WU5K**  
Type II

Grid in MH  
MH=10 Feet

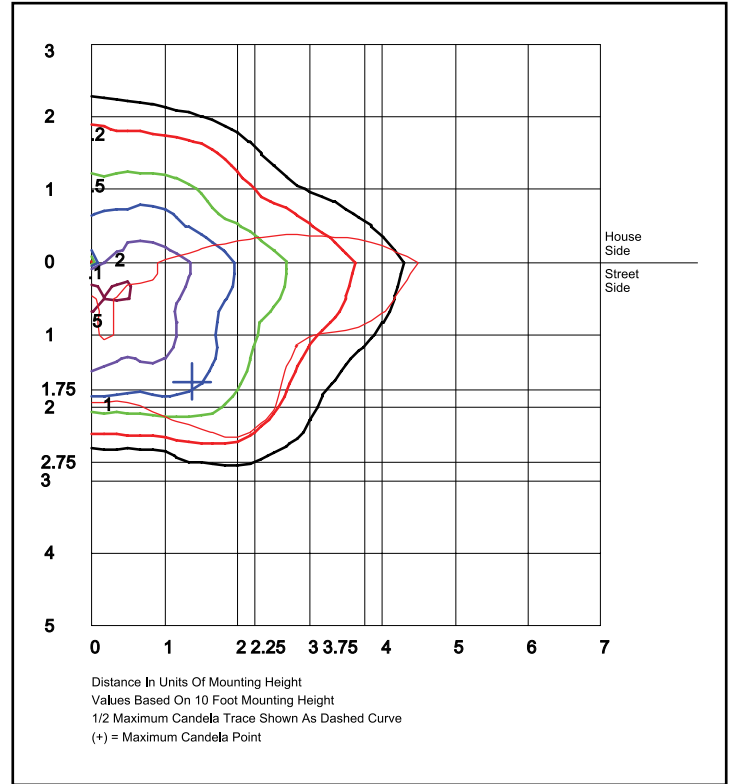

**WM12QC1X28WU5K**  
Type III

Grid in MH  
MH=10 Feet

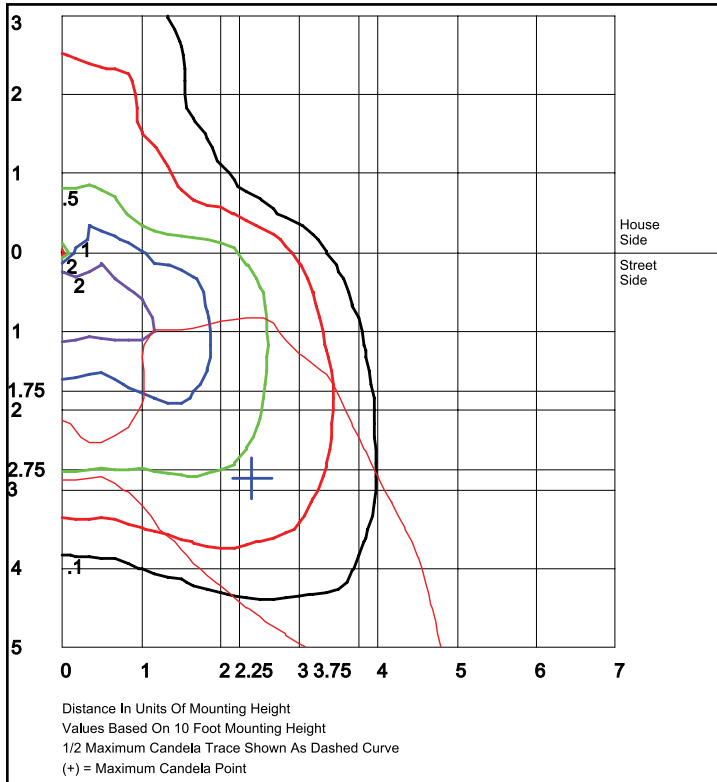

**WM12QD1X28WU5K**  
Type IV

Grid in MH  
MH=10 Feet

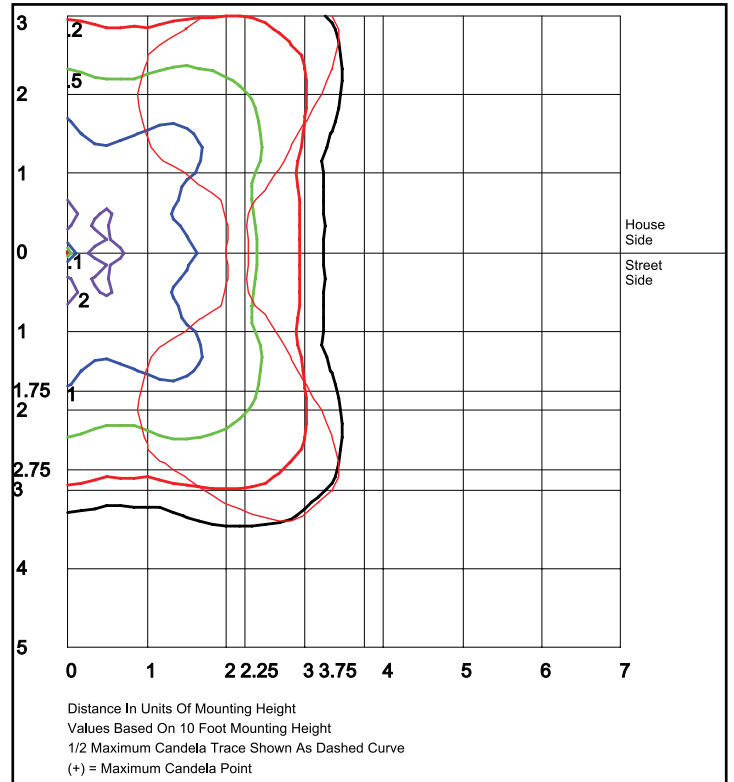

**WM12QF1X28WU5K**  
Type V

Grid in MH  
MH=10 Feet

Specifications subject to change without notice.

**WM12Q DuraLED Small Nautilus LED Post Top****DuraGuard**  
PRODUCTS INC.  
A QSSI Company**PHOTOMETRIC PERFORMANCE**

Optic	Wattage (Catalog Logic)	10W (1X10)	19W (1X19)	28W (1X28)
	Input Watts	10.3	20.5	30.8
	CCT	Delivered Lumens		
<b>WM12Q B=Type II</b>	3000K	833	1,666	2,499
	4000K	860	1,720	2,579
	5000K	893	1,787	2,680
	BUG Rating	B0-U0-G0	B0-U0-G1	B1-U0-G1
<b>WM12Q C=Type III</b>	3000K	876	1,752	2,628
	4000K	904	1,809	2,712
	5000K	939	1,879	2,818
	BUG Rating	B0-U0-G1	B1-U0-G1	B1-U0-G1
<b>WM12Q D=Type IV</b>	3000K	867	1,735	2,602
	4000K	895	1,790	2,686
	5000K	930	1,860	2,790
	BUG Rating	B0-U0-G1	B1-U0-G2	B1-U0-G2
<b>WM12Q F=Type V</b>	3000K	918	1,836	2,753
	4000K	947	1,894	2,841
	5000K	984	1,968	2,952
	BUG Rating	B1-U0-G1	B2-U0-G1	B2-U0-G1

**PROJECTED LUMEN MAINTENANCE**

Data shown for 5000 CCT		Compare to MH				
TM-21-11	Input Watts	Initial	25,000 Hrs	50,000 Hrs	100,000 Hrs	Calculated LED Life
<b>L70 Lumen Maintenance @ 25°C / 77°F</b>	All wattages up to and including 28w	1.00	0.96	0.92	0.84	187,000
<b>L70 Lumen Maintenance @ 50°C / 122°F</b>		1.00	0.93	0.87	0.73	113,000
<b>L80 Lumen Maintenance @ 40°C / 104°F</b>		1.00	0.97	0.93	0.86	144,000

**NOTES:**

- Projected per IESNA TM-21-11. Data references the extrapolated performance projections for the base model in a 25°C ambient, based on 10,000 hours of LED testing per IESNA LM-80-08.
- Compare to MH box indicates suggested Light Loss Factor (LLF) to be used when comparing to Metal Halide (MH) systems.